

THIS DRAWING IS A COPYRIGHT
 only figured dimensions are to be used. All dimensions
 to be checked on site or in the workshop prior to commencement of
 work, and any discrepancies are to be reported to the drawing originator.

LDĀDESIGN

Z:\9806_HERTFORD_GASWORKS_NORTHERN_PARCEL\TCD\DRAWINGS\9806_W408-LDA-PR-XX-GA-010-102_PARAMETERS_PLANDWG

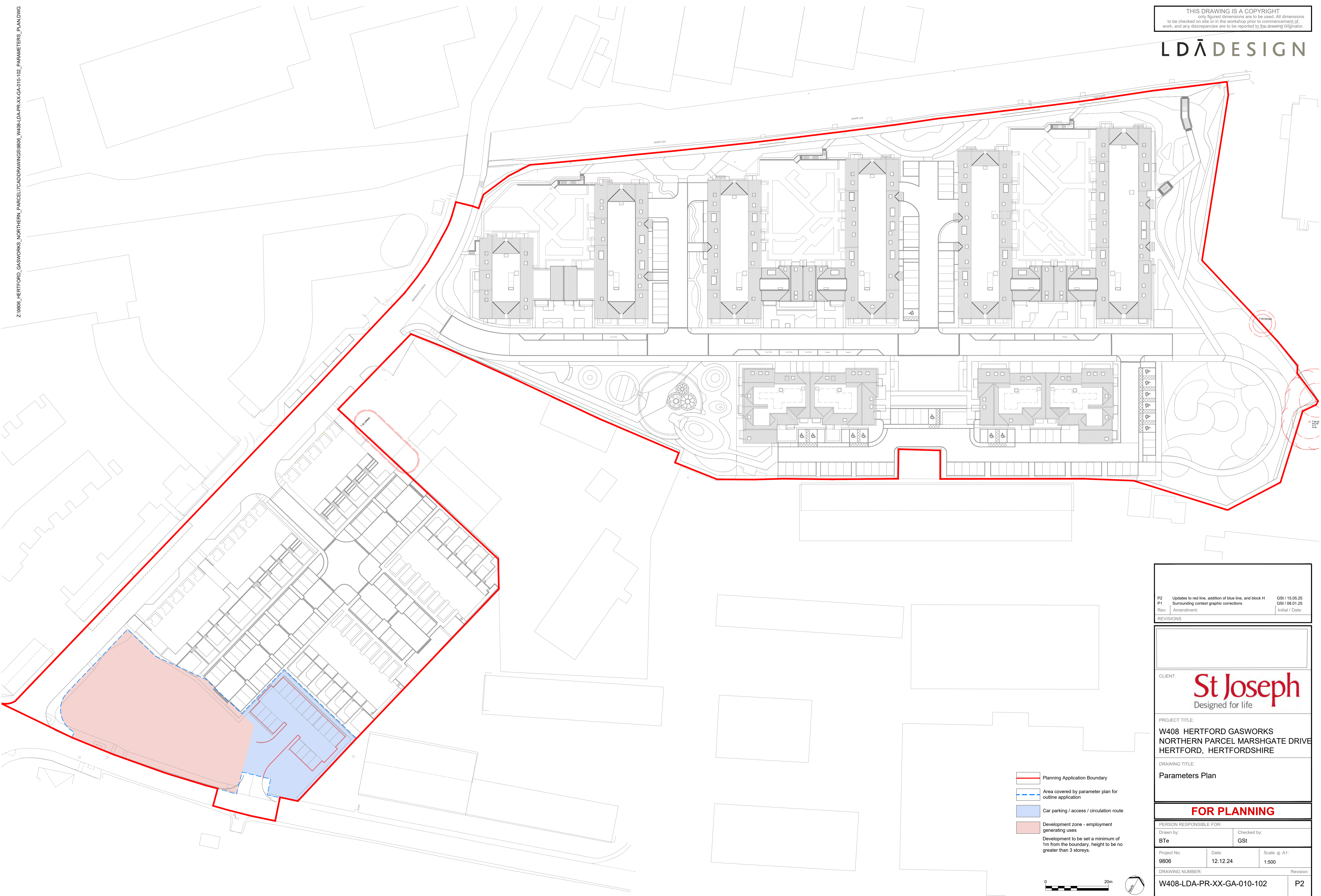

- Planning Application Boundary
- Area covered by parameter plan for outline application
- Car parking / access / circulation route
- Development zone - employment generating uses
 Development to be set a minimum of 1m from the boundary, height to be no greater than 3 storeys.

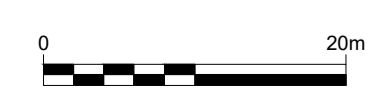

P2 P1	Updates to red line, addition of blue line, and block H Surrounding context graphic corrections Amendment: Initial / Date:	GSt / 15.05.25 GSt / 08.01.25 Initial / Date:
REVISIONS		
<div style="display: flex; justify-content: space-between; align-items: center;"> <div style="font-size: 8px;">CLIENT:</div> <div style="font-size: 24px; font-weight: bold; color: red;">St Joseph</div> </div> <div style="display: flex; justify-content: center; margin-top: 5px;"> Designed for life </div>		
PROJECT TITLE: W408 HERTFORD GASWORKS NORTHERN PARCEL MARSHGATE DRIVE HERTFORD, HERTFORDSHIRE		
DRAWING TITLE: Parameters Plan		
FOR PLANNING		
PERSON RESPONSIBLE FOR:		
Drawn by: BTe	Checked by: GSt	
Project No: 9806	Date: 12.12.24	Scale @ A1: 1:500
DRAWING NUMBER: W408-LDA-PR-XX-GA-010-102		Revision: P2